

İçerik

a) 1ad. Shell Kabuk

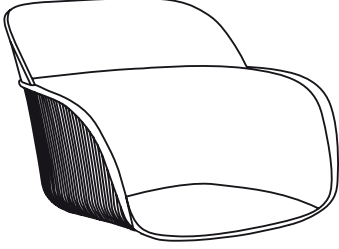

b) 1ad. Metal Ayak

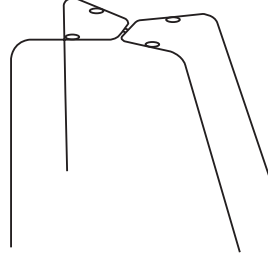

c) 4 ad. Pul



d) 4 ad. M6x20 Vida

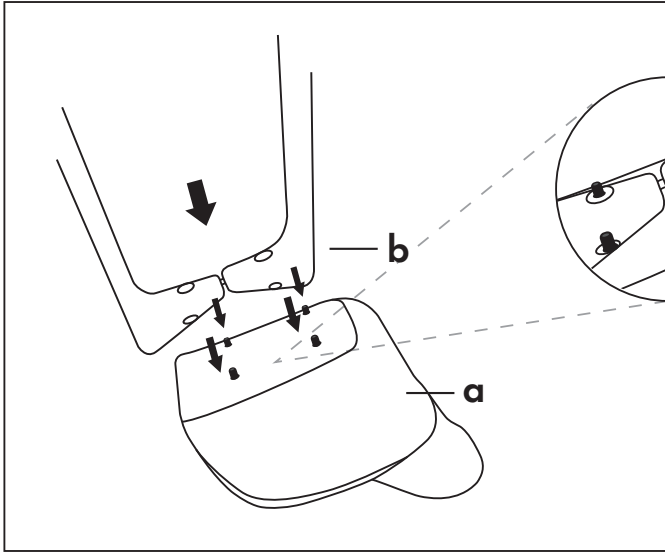

**1** Metal Ayak, Shell kabuđun alt kısmına, yüksek kısmı kabuđun ön tarafına denk gelecek şekilde yerleřtirilir.

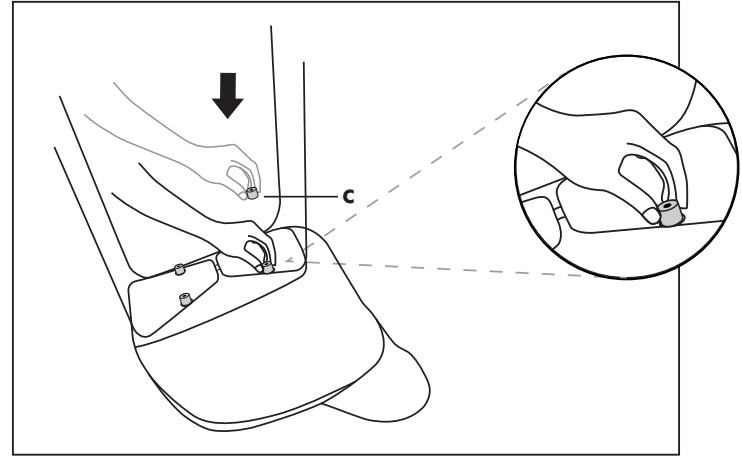

4 adet pul,  
Shell kabuđun altında bulunan  
pimlere yerleřtirilir. **2**

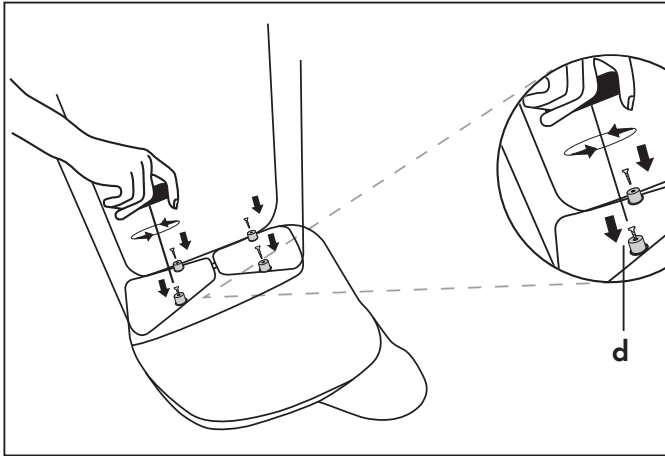

**3** 4 adet vida, pul yerleřtirilen kısımlara 6 alyan veya 6 alyan uçlu řarlı matkap ile sabitlenir ve kurulum tamamlanır.

## Contents

**a)** 1pc. Shell Seat

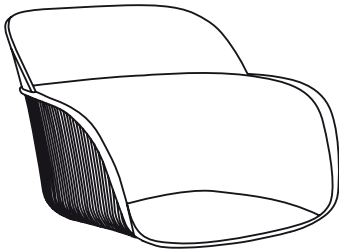

**b)** 1pc. Metal Leg

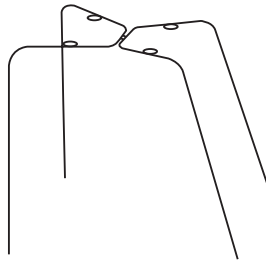

**c)** 4 pcs. Washer



**d)** 4 pcs. M6x20 Screw

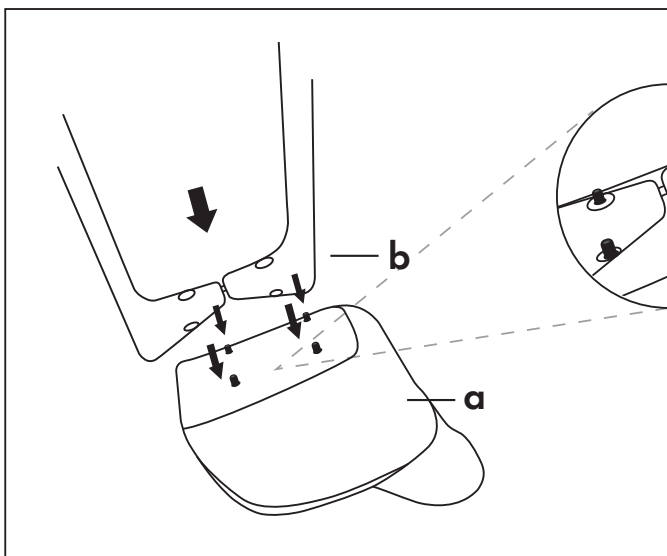

**1** The Metal Leg is placed on the down-side of the seat, with the higher part of the leg facing the front of the seat.

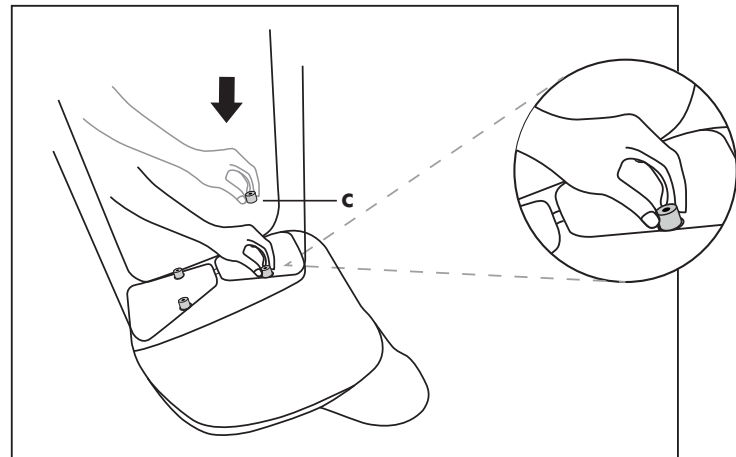

Place washers on the pins located under the seat. **2**

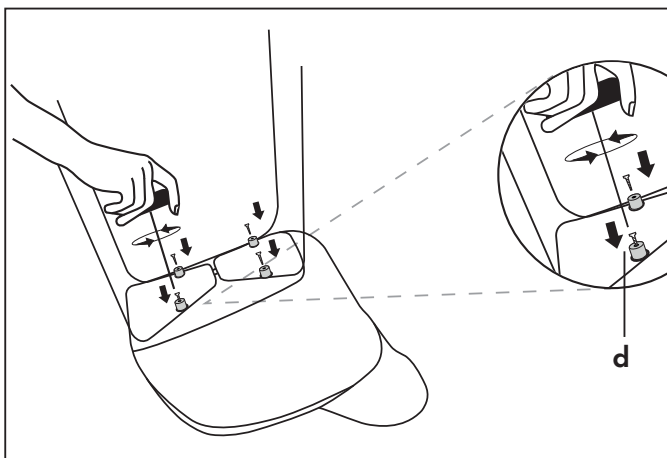

**3** Screw on all four washers with an allen or cordless drill with allen tip.